

Wall Blind Corner Cabinet Installation Notes

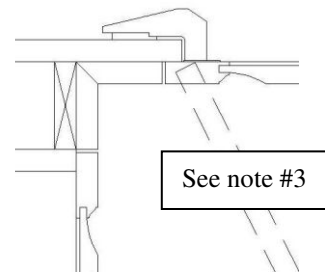
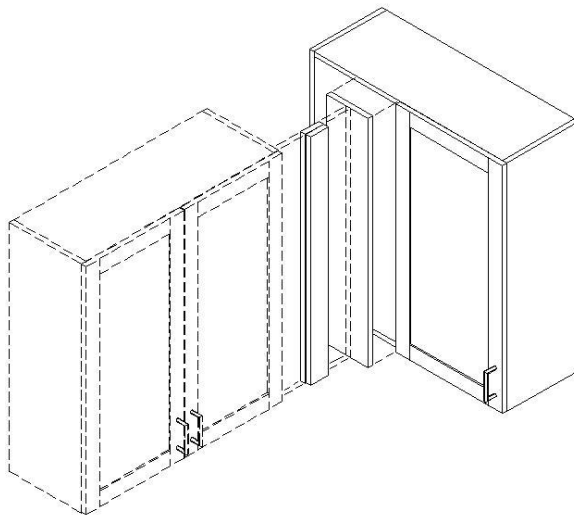

- 1 – Cabinet is designed for direct wall corner installation but may be pulled up to 3”.
- 2 – Your blind corner cabinet is shipped with an attached 7” wide slab overlay panel, w/ edges matching door edges.
- 3 – To create a 90° filler, remove the overlay panel, split it in half then miter the two panels together. Use a backer filler on the return so the overlay is flush with the adjacent cabinet doors as shown.