

Construction Details

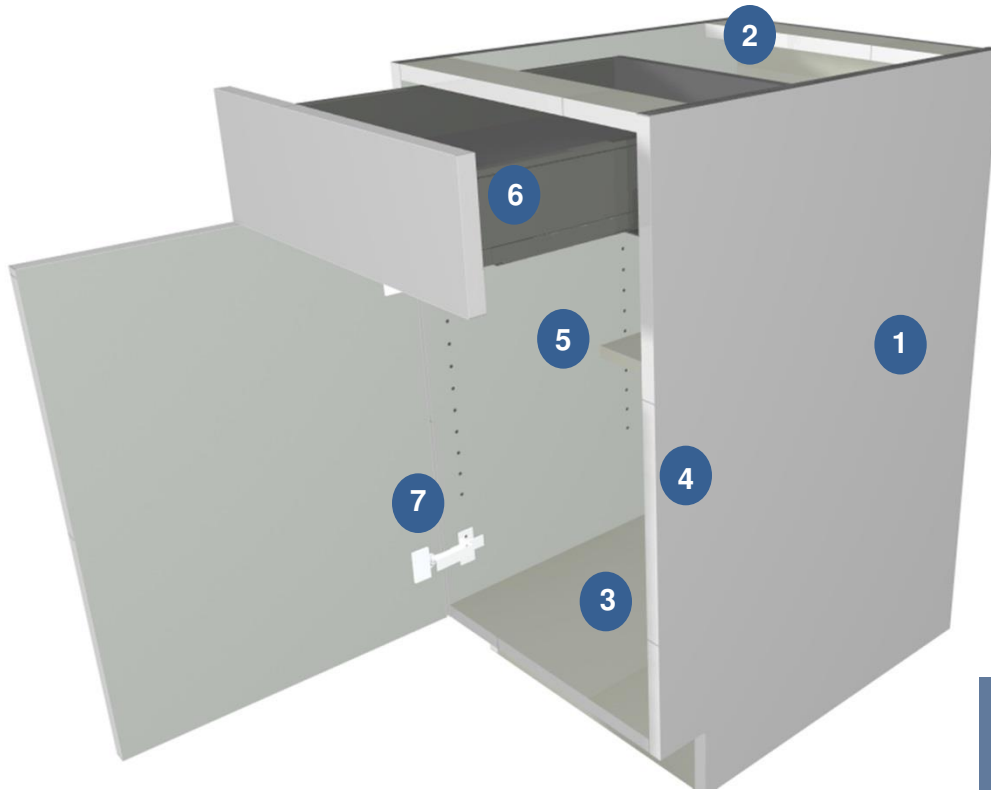

- 1 **Standard construction** consists of environmentally-friendly 3/4" furniture board. All sides, tops, bottoms, stretchers and shelving are 3/4" thick with 1/2" back panel.
- 2 **Cabinets are doweled** and glued before being assembled using an automated case clamp to ensure a rigid cabinet that is true and square.
- 3 **Interior components** and unfinished sides covered with white melamine. Finished ends and panels covered with a melamine complementary to the color of the door chosen.
- 4 **Front edges** are taped with coordinating PVC edgebanding.
- 5 **Shelving** is full depth on wall cabinets, half depth on standard base cabinets and full depth on full door base cabinets.
- 6 **Standard drawer box** consists of a 5/8" wood dovetail drawer and 1/4" captured bottom with a 7/8 extension Blum Edge undermount slide.
- 7 **Each door** has one soft-close, others standard fully concealed Blum 107 degree quick release hinges with 3-waycam adjustment.

Norwood Factory & Showroom

505 University Avenue
 Norwood, MA 02062
 781-949-8900

Metcabinet.com