

## Framed inset construction

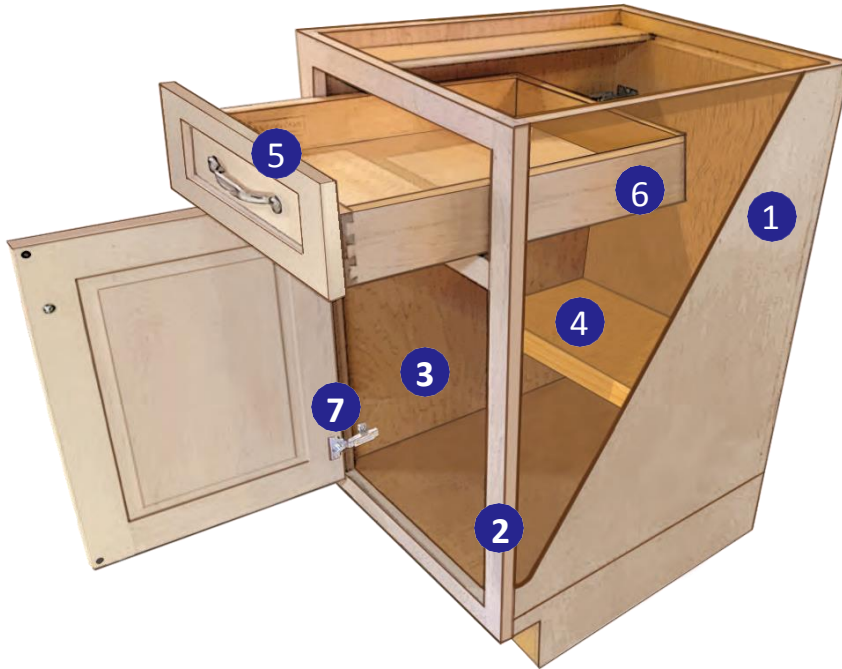

- 1 **Standard construction** consists of NAUF (No Added Urea-Formaldehyde) Plywood. 3/4" sides, tops and bottoms with a 1/2" thick plywood back.
- 2 **Cabinets are dado** and glued, while a solid wood face frame is attached using the same dado method and a spline firmly secures the face frame to the cabinet box. Cabinets are individually hand clamped to ensure a rigid cabinet that is true and square.
- 3 **Interior components** are clear finished natural maple wood veneers. Unfinished sides are covered with a raw maple wood veneer. Finished ends, interiors and panels are covered with wood veneer finishes to match doors.
- 4 **Shelving** is full depth on wall cabinets, half depth on standard base cabinets and full depth on full door base cabinets.
- 5 **Drawer box standard** is a 5/8" solid maple dovetail drawer with 1/4" plywood captured bottom
- 6 **Slide standard** is Blumotion full extension with soft-close feature.
- 7 **Hinges are fully concealed** 110 quick release with integrated soft-close and 3 way cam adjustment. Optional exposed finial hinge in an assortment of finishes.

### Norwood Factory & Showroom

505 University Avenue  
Norwood, MA 02062  
781-949-8900

[Metcabinet.com](http://Metcabinet.com)