

ShowHouse
CUSTOM CABINETS

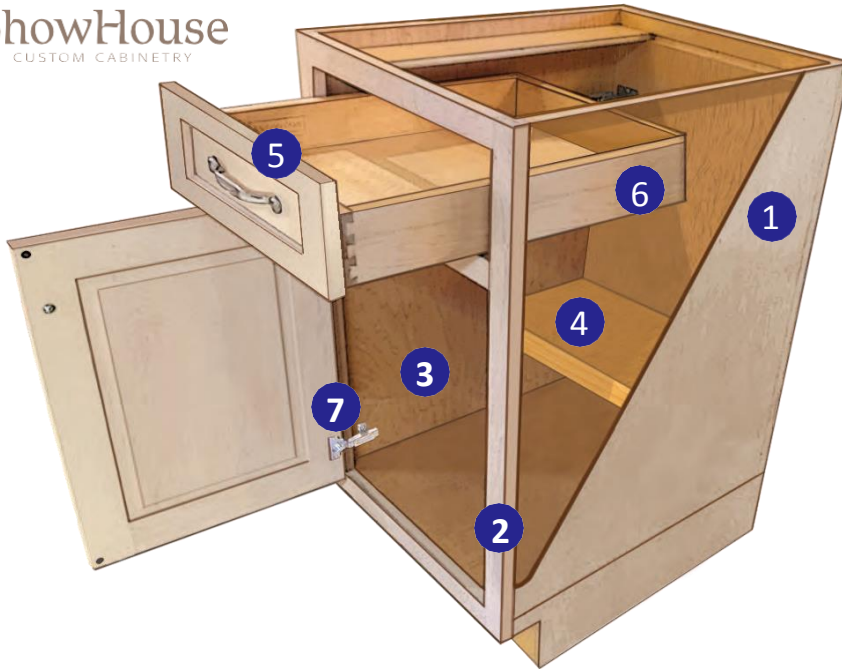

- 1 Standard construction** consists of NAUF (No Added Urea-Formaldehyde) Plywood, using a combination of 3/4" and 1/2" thick plywood is used to construct the cabinet box.
- 2 Cabinets are dado** and glued, while a solid wood face frame is attached using the same dado method and a spline firmly secures the dace frame to the cabinet box. Cabinets individually hand clamped to ensure a rigid cabinet that is true and square.
- 3 Interior components** are clear finished natural maple wood veneers. Unfinished sides are covered with a raw maple wood veneer. Finished ends, interiors or panels covered with real wood veneer to match your doors or optional wood panels.
- 4 Shelving** is full depth on wall cabinets, half depth on standard base cabinets and full depth on full door base cabinets.
- 5 Standard** is a 5/8" solid maple dovetail drawer with 1/4" plywood captured bottom
- 6 Full extension** Blumotion with soft-close feature.
- 7 Blum fully concealed** 110 quick release with integrated soft-close and 3 way cam adjustment. Optional exposed finial hinge in an assortment of finishes.

Norwood Factory & Showroom

505 University Avenue
Norwood, MA 02062
781-949-8900

Metcabinet.com